

TESA Axial Miniature Probes

Standard probes

Compact probes specially designed for use where there's no room for longer probes – Possible assembly on measuring heads for bore measurement and the like.



GT 41 GT 43

GT 41 and GT 43 probes with axial cable exit

		Measuring range (mm)		N*	Measuring bolt retraction	Sealing bellows	
<i>Measuring bolt hanging from a diaphragm spring</i>							
03230001	GT 41	± 0,3	0,63	without	nitrile		
<i>Measuring bolt mounted on a plain bearing</i>							
03230035	GT 43	± 1	0,4	mechanical	Viton		



GT 42

GT 42 and GT 44 probes with radial cable exit

		Measuring range (mm)		N*	Measuring bolt retraction	Sealing bellows	
<i>Measuring bolt hanging from a diaphragm spring</i>							
03230002	GT 42	± 0,3	0,63	vacuum	nitrile		
<i>Measuring bolt mounted on a plain bearing</i>							
03230017	GT 44	± 1	0,4	vacuum	Viton		

* Nominal value at electrical zero, max. ±25%. Valid in upright assembly position with downward oriented measuring bolt, as well as in static measuring.



GT 44

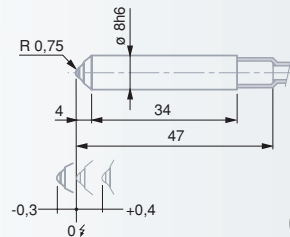

GT 41

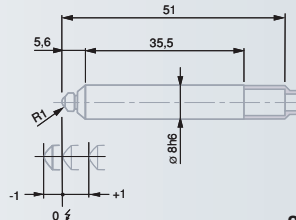

GT 43

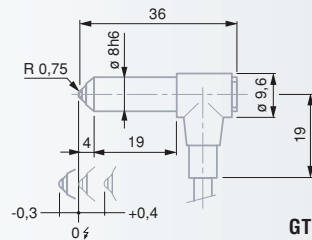

GT 42

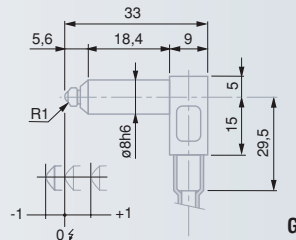

GT 44

	Measuring bolt stops**		mm	µm	µm	µm***	Technical data sheets
	lower (mm)	upper (mm)					
GT 41	-0,3	0,4	0,7	0,01	0,01	0,2 + 5 · L ²	03200258
GT 43	-1,05	1,05	2,1	0,1	0,15	0,2 + 5 · L ²	03200260
GT 42	-0,3	0,4	0,7	0,01	0,01	0,2 + 5 · L ²	03200259
GT 44	-1,05	1,05	2,1	0,1	0,15	0,2 + 5 · L ²	03200261

** Distance from electrical zero. *** Linearity related max perm. errors (L in mm).

